



ClassicCash

CASH TO CARD

HighSecurity

CASH TO CARD

Revalue Stations Installation Manual



Installation Safety Precautions

Read all instructions before beginning installation. Make sure all devices are unpowered during installation.

Voltage Warning: Before connecting the equipment to a power source, be sure the voltage supplied is the same as that specified for the equipment. If in doubt, do not connect the equipment! Contact Heartland MicroPayments' Customer Service for assistance.

General Description

These units allow the user to transfer funds from currency to the stored value card for use within the system in place at the installation. Additionally, users can purchase pre-valued cards from properly equipped devices.

When the user inserts a valid card, the available balance is displayed. The user then inserts currency, the value is added to the stored value card, the new balance is displayed on the reader, and the transaction is complete. Purchasing a card required that the user press the 'Buy Card' button, and insert the required denomination of currency. The card is then dispensed to the user.

Auditing of these Revalue Stations is accomplished with the use of a Palm Data Collector, which will retrieve information on transactions during the current period and store them for transfer to a personal computer for report printing. The period totals are reset each time the transaction data is collected. Verification of the accuracy of currency received is achieved through a mechanical currency counter(s), located inside the Card Revalue Station, which displays the running total of currency received in the device, and the number of cards that have been dispensed.

Physical Specifications

ClassicCash Revalue Station

Dimensions: 18"(h) x 12"(w) x 12"(d)

Weight Approximately 65 pounds

Power requirements 90-125 VAC 50/60 Hz @ <1A

Mounting options: External wall or on pedestal

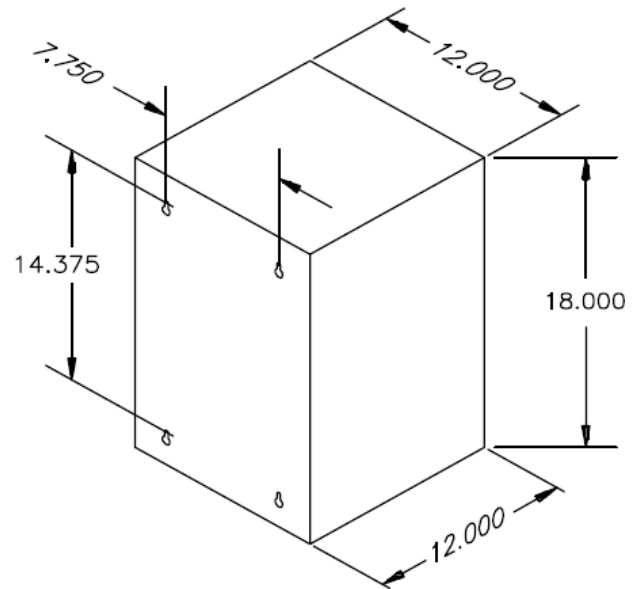

Pedestal Dimensions: 38"(h) x 12"(w) x 12"(d)

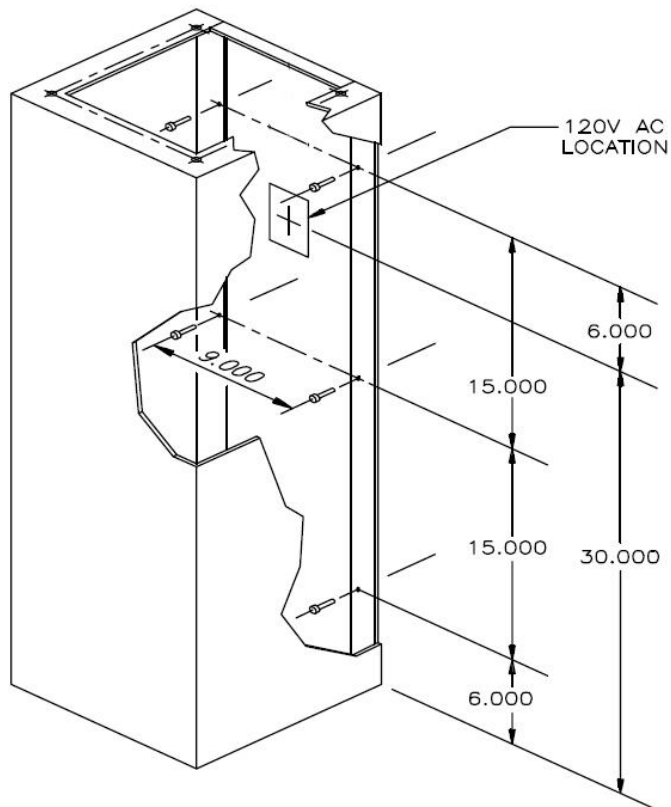

Physical Specifications

HighSecurity Revalue Station

Dimensions: 26.5"(h) x 16.73"(w) x 12"(d)

Weight Approximately: 126 pounds

Power requirements 90-125 VAC 50/60 Hz @ <1A

Mounting options: External wall or on pedestal

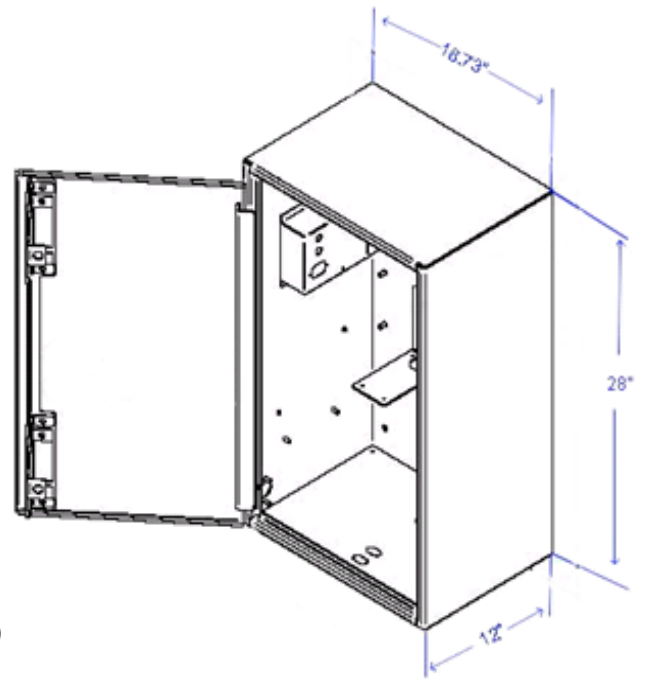

Pedestal Dimensions: 26.5"(h) x 16.73"(w) x 12"(d)

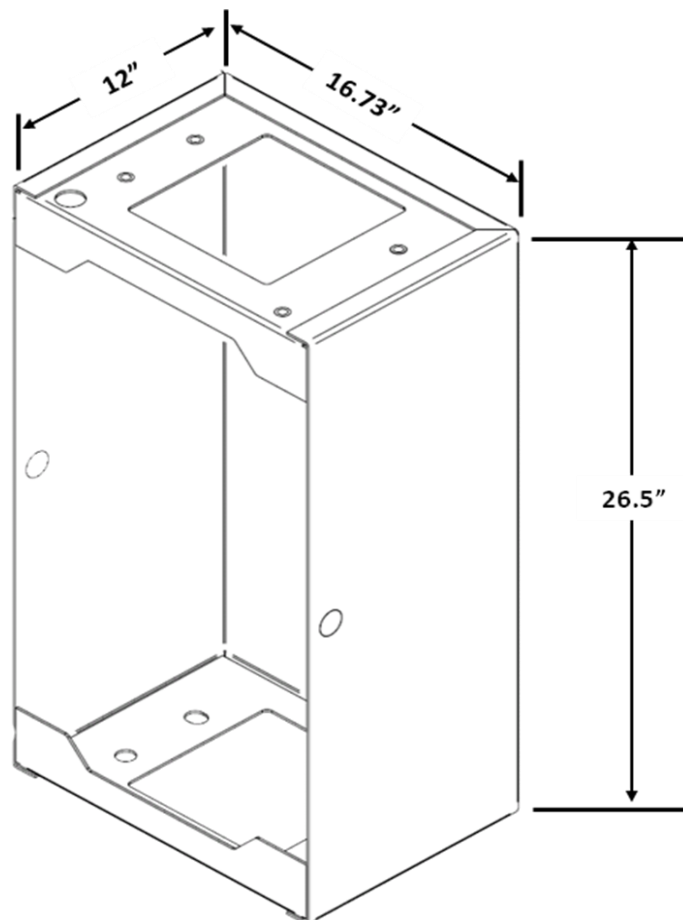

Mounting the Revalue Stations

The Heartland MicroPayments Card Revalue Stations may be mounted on a pedestal or wall. Mounting holes are located on the cabinetry, but it is the responsibility of the purchaser to ensure a secure attachment to the wall, as well as to provide the mounting hardware.

Note: Regardless of the type of mounting, the wall must be capable of supporting any stress that the attached equipment may be subjected to. Inadequate support may result in the equipment falling, causing risk of impact injury, electrical shock, and/or fire.



ClassicCash

External Wall Mounting

The back of the ClassicCash Revalue Station enclosure contains four slotted holes for wall mounting. The diameter of the narrow end of the slot is sufficiently large to accommodate a 1/4" diameter bolt. The bolt heads can be no larger than 1/2" maximum diameter. The holes are spaced 7-3/4" center to center horizontally, and 14-3/8" center to center vertically. After installing any necessary support, insert the bolts into the wall, tightening to leave approximately 1/2". Place the Card Revalue Station onto the support, inserting the bolt heads into the large portion of the slotted hole. Lower the case until it is held by the supports, and then tighten the bolts.

Pedestal Mounting

The pedestal is a 42" x 12" x 12" metal stand with an open back. The back contains six holes placed 6", 30", and 36" from the bottom, and 1-1/2" from the sides. These holes are 3/8" in diameter and are used to mount the pedestal to the wall. The top of the pedestal has a hole in each corner for mounting to the Card Revalue Station case. These holes are located 1-1/2" from each side and have nuts welded to the underside. Mount the pedestal to the wall, then place the Card Revalue Station on top and secure through the bottom of the enclosure with the supplied bolts. You may, in addition, mount the back of the Card Revalue Station to the wall for extra support.

HighSecurity

External Wall Mounting

The back of the HighSecurity Revalue Station enclosure contains four holes for wall mounting. The diameter of the narrow end of the slot is sufficiently large to accommodate a 3/8" diameter bolt. The bolt heads can be no smaller than 1/2" minimum diameter (a use of a 1" flat washer [steel] is also required). The holes are spaced 12-1/2" center to center horizontally, and 22-1/8" center to center vertically. After installing any necessary support anchors, two persons must lift the box into place on the wall, while a third person inserts the bolts into the wall anchors, from the inside of the box, level the Revalue Station, then tighten the bolts.



Pedestal Mounting

The pedestal is a 42" x 12" x 12" metal stand with an open back. The back contains six holes placed 6", 30", and 36" from the bottom, and 1-1/2" from the sides. These holes are 3/8" in diameter and are used to mount the pedestal to the wall. The top of the pedestal has a hole in each corner for mounting to the Card Revalue Station case. These holes are located 1-1/2" from each side and have nuts welded to the underside. Mount the pedestal to the wall, then place the Card Revalue Station on top and secure through the bottom of the enclosure with the supplied bolts. You may, in addition, mount the back of the Card Revalue Station to the wall for extra support.

Powering the Card Revalue Station

Power is supplied to the Card Revalue Station via a line cord provided with your unit. Plug the female end into the power distribution panel by running the cord through the electrical connection located on the back of the cabinet. This cord should be connected to a dedicated power source according to the electrical requirements for the equipment as stated in the specifications.

To power the unit after the electrical connection has been made, flip the toggle switch on the power distribution panel.

Configuration and Programming

Prior to use, your Card Revalue Station must be configured and programmed to operate as designed. Refer to the Quick Set-Up instructions for Configuration and Programming Steps provided with your unit.

Security



Anti-theft software built into the Card Revalue Stations with bill acceptors causes the machine to inhibit function if powered off for a period of greater than seven minutes. In this condition, the unit will lockup and display an "OUT OF SERVICE 67" error message. To enable the unit, the operator must clear the lockup according to the enable procedures as outlined in the Heartland MicroPayments Card Revalue Station Secure Operations Manual.

Heartland MicroPayments ReValue Stations are shipped with generic lock & key assemblies. It is strongly recommended that these be replaced before installing the ReValue Stations. A recommended source for these locks is **Locking Systems, Inc.**, 800-657-5625, <http://www.lockingsystems.com/vendinglocks.htm>.